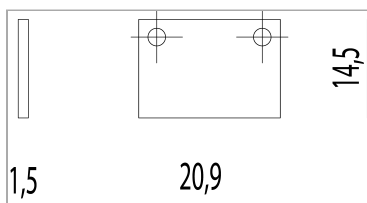

**Couple of closure heads for superslim
recessed profile**

code MF42TI/27

**PRODUCT DESCRIPTION**

Series of fixtures to be ceiling-mounted, recessed or trimless-recessed within flat surfaces or to be trimless-recessed in external and internal angles. Direct diffused lighting emission. Linear LED sources, to be completed with remote 24Vdc driver. Body in extruded aluminium, painted finish, complete with opal white polycarbonate diffuser. Light Proof system side-end caps. Degree of protection IP40 or IP65.

PRODUCT SPECS

Installation method	system
Finishing	Oxidised aluminium
Dimension	mm

WEB PAGE**ASSEMBLY
INSTRUCTIONS**

Complies with EN605981 and related notes. In the absence of metric symbols, the measurements are all in millimetres.

Luminous flux and power data are initially subject to tolerances +/- 10%. The values refer to an ambient temperature of 25°C unless otherwise specified.

We reserve the right to make changes to our products at any time.

Page 1 / 1