

Focus Mini Track T26 trimless back recessed

code FS501A.930FD/01

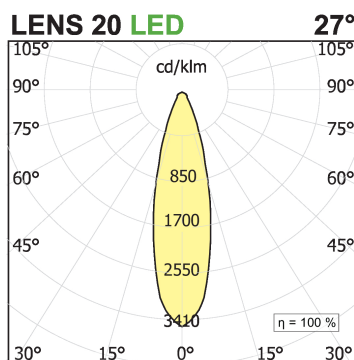
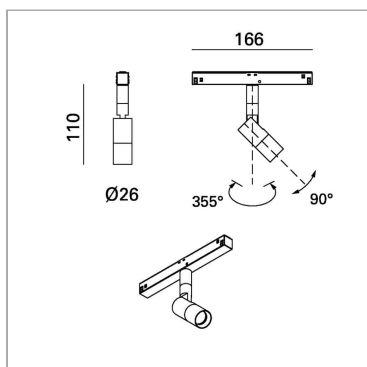
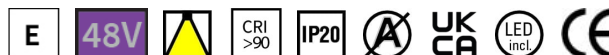

PRODUCT DESCRIPTION

Cylindrical projector in extruded aluminum for installation on Mini Track System, electrified track in very low voltage; installation and positioning by means of quick-coupling insertion tools free; adjustable on the vertical axis of 355 and on the horizontal axis of +/- 90; powder coating or galvanic treatment; with COB (Chip on Board) technology for maximum efficiency; absence of multiple shadows; energy efficient LEDs with high color rendering; on-board electronic converter with Dali2 DT8 2-channel protocol; rear optical group; secondary lens in high transparency pmma; optical units available as accessories with replacement without tools; hot plug protection and power supply without respect for polarity; available accessories such as honey comb, elipsoid lens, asymmetric lens, satined lens. Color finish white.

PRODUCT SPECS

Installation method	Track
Light source	LED
Absorbed power	5,7 W
Color temperature	3000K
Color rendering index CRI	>90
Optic	Flood 27°
Finishing	White
Luminous flux of the product	571 lm
Luminous efficiency	100 lm/W
MacAdam color tolerance	3
Life time estimate	3SDCM 50000h L90 B10 Ta 25°C
Protocol	Dimmable Dali
Energy efficiency class	E
Dimension	W166 Ø26 mm
IP Grade	IP20
Power supply/Transformer	Not included
Protocol	See power supply

WEB PAGE



ASSEMBLY INSTRUCTIONS



Complies with EN605981 and related notes. In the absence of metric symbols, the measurements are all in millimetres.

Luminous flux and power data are initially subject to tolerances +/- 10%. The values refer to an ambient temperature of 25°C unless otherwise specified.

We reserve the right to make changes to our products at any time.

Page 1 / 1