

Incas 45-90 Recessed 45

code IN45.G9/01

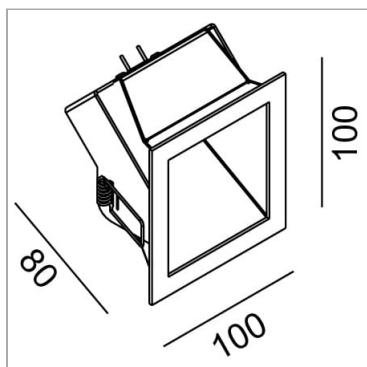
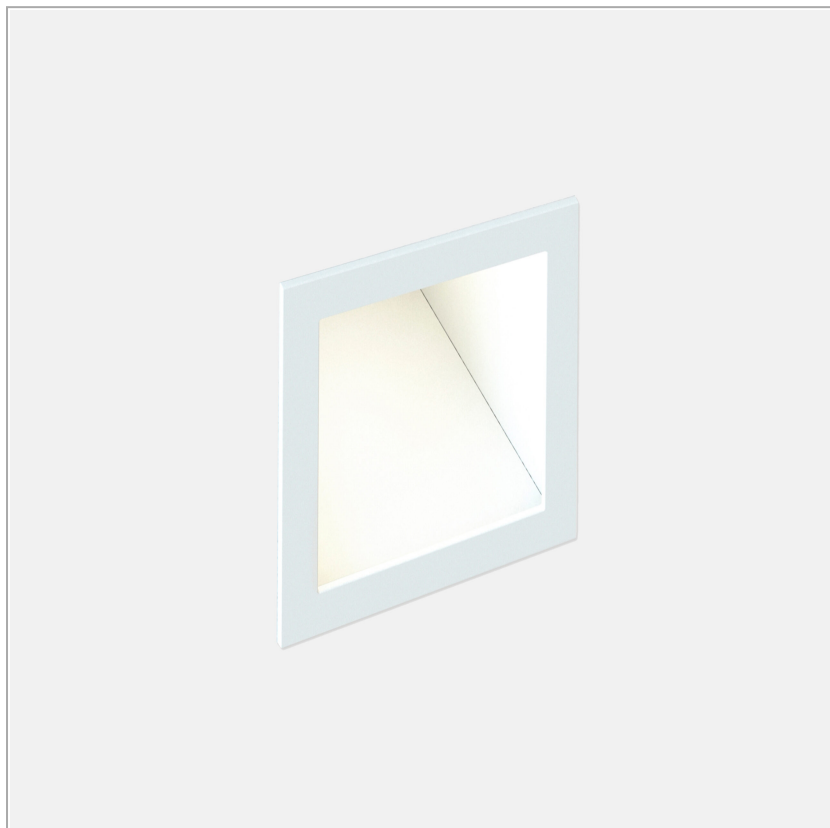

PRODUCT DESCRIPTION

recessed fixture designed with square frame. The light is direct with an angle of 45°

PRODUCT SPECS

Installation method	Recessed with frame
Light source	Led
Absorbed power	5 W
Color rendering index CRI	>90
Finishing	White
MacAdam color tolerance	3
Durata media stimata	50000h L90 B10 ta 25°C
Power supply/transformer	Not included
Energy efficiency class	D
Dimension	L100Wx80Hx100 mm
Hole size	squared cut 92X90 mm
IP Grade	IP20

WEB PAGE



ASSEMBLY INSTRUCTIONS



MANDATORY ACCESSORIES

Accessori Frosted glass diffuser

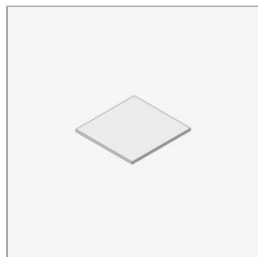

code VT/IN45.90

Collection of recessed fixture designed with square frame. Mount different light sources: halogen 12V, 230V or 1W 3W LED. Direct light or diffused light thanks to an optional frosted glass. 90 and 45 indicate the angle of light: 90° for INCAS 90 and IINCAS 90 MICRO and 45° for INCAS 45 and INCAS 45 MICRO. Available steel housing for brick walls.

Technical Sheet



Accessori Wallbox Wallbox incas 90 – 45

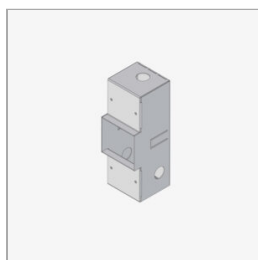

code CC94

Galvanized metal wallbox to be recessed in brick walls or reinforced concrete to fit the article INCAS 90,45.

Technical Sheet



