

## Focus Mini Track T55 trimless back recessed

code FS503A.930F/01

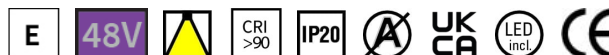

### PRODUCT DESCRIPTION

Cylindrical projector in extruded aluminum for installation on Mini Track System, electrified track in very low voltage; installation and positioning by means of quick-coupling insertion tools free; adjustable on the vertical axis of 355 and on the horizontal axis of +/- 90; powder coating; with COB (Chip on Board) technology for maximum efficiency; absence of multiple shadows; energy efficient LEDs with high color rendering; on-board electronic converter with Dali2 DT8 2-channel protocol; rear optical group; secondary lens in high transparency pmma; optical units available as accessories with replacement without tools; hot plug protection and power supply without respect for polarity; available accessories such as honey comb, elipsoid lens, asymmetric lens, satined lens. Color finish white.

### PRODUCT SPECS

Installation method	Track
Light source	LED
Absorbed power	18 W
Color temperature	3000K
Color rendering index CRI	>90
Optic	Flood 27°
Finishing	White
Luminous flux of the product	1102 lm
Luminous efficiency	61 lm/W
MacAdam color tolerance	3
Life time estimate	50000h Ta 25° L80 B10
Protocol	On/Off
Energy efficiency class	E
Dimension	W166 Ø55 mm
IP Grade	IP20
Power supply/Transformer	Not included
Protocol	See power supply

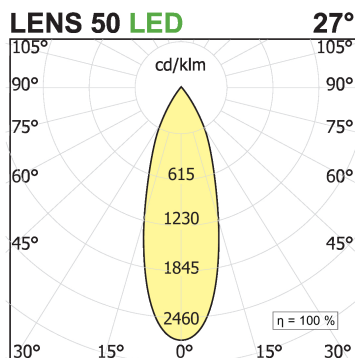
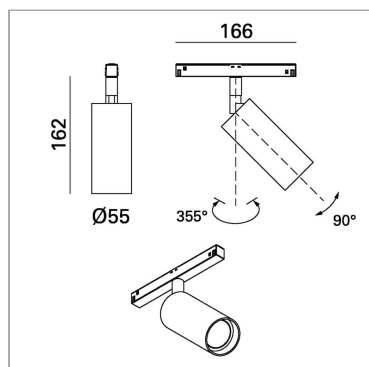

### WEB PAGE



### ASSEMBLY INSTRUCTIONS



Complies with EN605981 and related notes. In the absence of metric symbols, the measurements are all in millimetres.

Luminous flux and power data are initially subject to tolerances +/- 10%. The values refer to an ambient temperature of 25°C unless otherwise specified.

We reserve the right to make changes to our products at any time.

Page 1 / 2

## OPTIONAL ACCESSORIES

### Accessori Lens With Ring Asymmetric lens with ring ø55



code L055A.A/01

Sistema modulare per illuminazione diretta, indiretta e/o d'accento, composto da profili vuoti in estruso di alluminio verniciato o anodizzato 90x30 mm. di lunghezza predefinita o tagliabili a misura. Da integrare con sorgenti lineari LED, proiettori. Da completare con le testate di chiusura laterali con sistema Light Proof, schermo diffondente in PC opalino bianco, cover di chiusura cieche.

Technical Sheet

