



MINI INCAS



DOWNLIGHT

MINI INCAS

Proiettore da incasso, per installazioni trimless o con battuta, dotato di monocolo telescopico estraibile e orientabile, per sorgente LED GU10 230V/240V, con corpo e monocolo telescopico in metallo verniciato.

La versione trimless necessita obbligatoriamente di controtelaio per installazione su controsoffitti in cartongesso da 13mm. Installabile anche in pareti e soffitti in calcestruzzo mediante apposita cassaforma in lamiera zincata disponibile come accessorio. Grado di protezione IP20/IP23

Recessed projector, for trimless or trimmed installations, equipped with removable and adjustable telescopic monocol, for GU10 LED source 230V/240V, with body and telescopic monocol in painted metal. The trimless version necessarily requires counterframe for installation on 13mm plasterboard false ceilings. Extruded aluminum formwork for concrete recessed installation available as an accessory. IP20/IP23.





MINI INCAS MINIMAL

vedi accessori    

MINI INCAS 1 MINIMAL

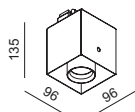

GU10 LED 

W	Dim.	H	Kg	CODE	Col.
1x max 50	96x96	135	0,55	LT1202	/01 /02

Da completare con telaio per controsoffitto o cassaforma per cemento/laterizio | To be completed with frame for false ceiling or wallbox brick/concrete

MINI INCAS 2 MINIMAL

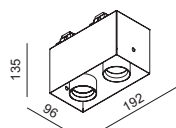

GU10 LED 

W	Dim.	H	Kg	CODE	Col.
2x max 50	96x192	135	1,00	LT1208	/01 /02

Da completare con telaio per controsoffitto o cassaforma per cemento/laterizio | To be completed with frame for false ceiling or wallbox brick/concrete

MINI INCAS 3 MINIMAL

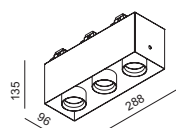

GU10 LED 

W	Dim.	H	Kg	CODE	Col.
3x max 50	96x288	135	1,25	LT1216	/01 /02

Da completare con telaio per controsoffitto o cassaforma per cemento/laterizio | To be completed with frame for false ceiling or wallbox brick/concrete

MINI INCAS FRAME

vedi accessori    

MINI INCAS 1 FRAME

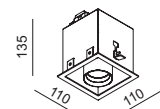
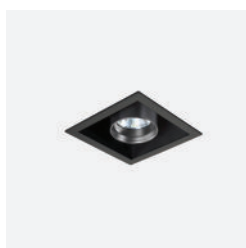

GU10 LED 

W	Dim.	H	Kg	CODE	Col.
1x max 50	110x110	135	0,55	LT1205	/01 /02

MINI INCAS 2 FRAME

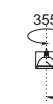
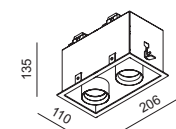

GU10 LED 

W	Dim.	H	Kg	CODE	Col.
2x max 50	110x206	135	1,00	LT1212	/01 /02

MINI INCAS 3 FRAME

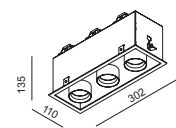

GU10 LED 

W	Dim.	H	Kg	CODE	Col.
3x max 50	110x332	135	1,25	LT1220	/01 /02

CASSAFORME E TELAI - WALLBOXES AND INSPECTABLE FRAME

TELAIO MINI INCAS MINIMAL

FRAME FOR MINI INCAS M

Telaio ispezionabile da fissare e stuccare nel cartongesso da 15mm. per cartongessi da 13mm spessorare
inspectable frame to be fixed and plastered in 15mm height plasterboard false ceilings

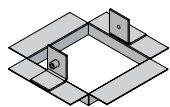

MINI INCAS 1M

102x102

CODE

MSC21

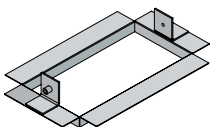

MINI INCAS 2M

102x199

CODE

MSC22

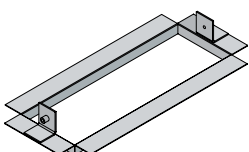

MINI INCAS 3M

102x293

CODE

MSC23

Cassaforma in lamiera zincata per installazione in laterizio o calcestruzzo - galvanized metal wallbox for installing in brick or reinforced concrete

CASSAFORMA MINI INCAS

WALLBOX MINI INCAS

FRAME

MINIMAL

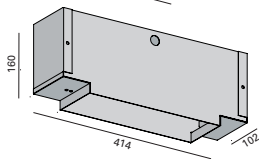
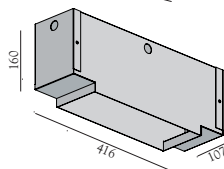
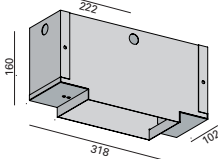
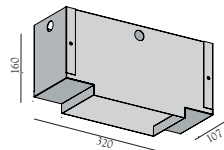
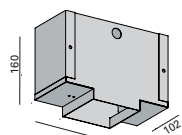
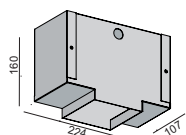

	Dim.	H	CODE
MINI INCAS 1 FRAME	107x224	160	MSC01
MINI INCAS 1 MINIMAL	102x222	160	MSC11

	Dim.	H	CODE
MINI INCAS2 FRAME	107x320	160	MSC02
MINI INCAS 2M MINIMAL	102x318	160	MSC12

	Dim.	H	CODE
MINI INCAS3 FRAME	107x416	160	MSC03
MINI INCAS 3M MINIMAL	102x414	160	MSC13