

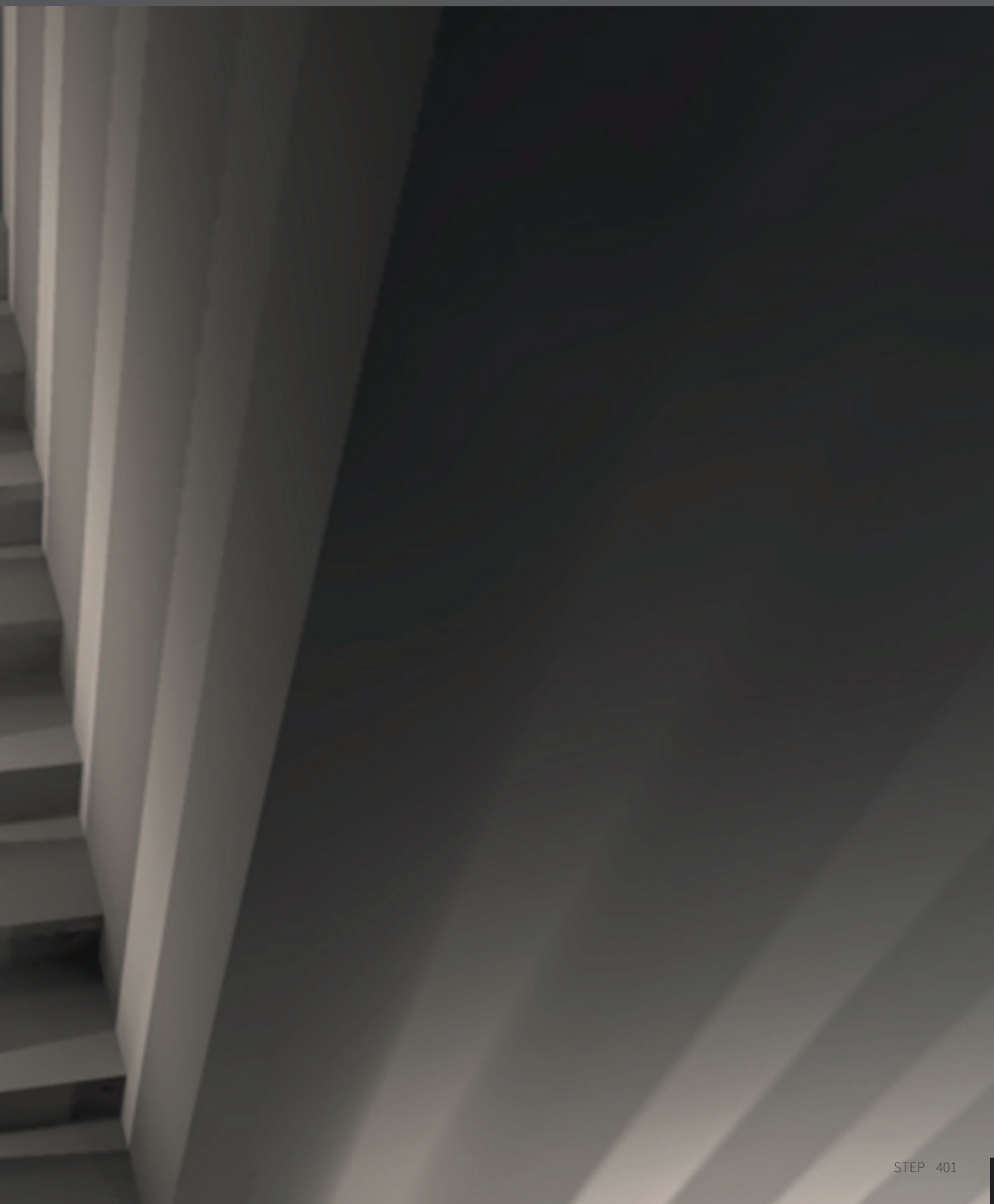

STEP



DOWNLIGHT

STEP

Apparecchio da incasso a parete per illuminazione segnapasso direzionata con angolo di 20°, per sorgente LED integrata con alimentazione remota disponibile come accessorio. Corpo e cornice di battuta in metallo verniciato. Installabile anche in pareti e soffitti in calcestruzzo mediante apposita cassaforma in lamiera zincata disponibile come accessorio. Grado di protezione IP20.

Recessed wall luminaire for path lighting with 20 ° angle, for integrated LED source with remote power supply available as accessory. Body and frame in painted metal. It can, also, be installed in concrete or brick ceilings using a special galvanized metal outercasing available as accessory. IP20.

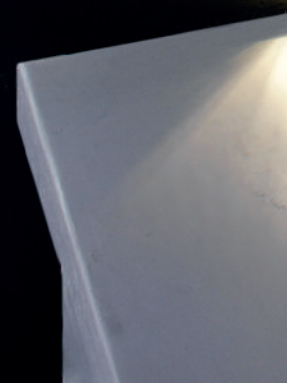



DOWNLIGHT

STEP 75

29X69

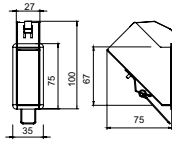

LED					lm product/beam 3000K		CODE	Col.
W	mA	Dim.	H	Kg	16°			
1,5	500	27x75	67	0,2	252	LT1983BC	/01 /02	

Accessori - accessories: LT1992: cassaforma step 75 - Wallbox step 75

STEP 150

29X144

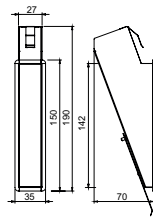

LED					lm product/beam 3000K		CODE	Col.
W	mA	Dim.	H	Kg	16°			
1,5	500	27x70	142	0,4	252	LT1982BC	/01 /02	

Accessori - accessories: LT1991: cassaforma step 150 - Wallbox step 150

STEP 300

29X372

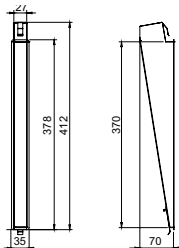

LED					lm product/beam 3000K		CODE	Col.
W	mA	Dim.	H	Kg	16°			
1,5	500	27x70	370,7	252		LT1981BC	/01 /02	

Accessori - accessories: LT1990: cassaforma step 300 - Wallbox step 300

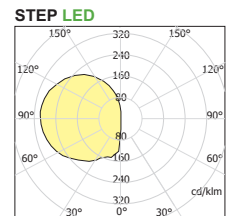

CASSAFORMA WALLBOX

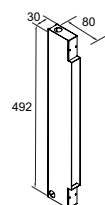
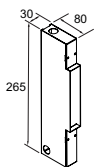
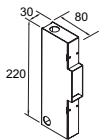

	Dim.	H	CODE
STEP75	30x80	220	LT1992

Idonea anche per calcestruzzo. Suitable also for brickwall.

	Dim.	H	CODE
STEP150	30x80	265	LT1991

Idonea anche per calcestruzzo. Suitable also for brickwall.

	Dim.	H	CODE
STEP300	30x80	492	LT1990

Idonea anche per calcestruzzo. Suitable also for brickwall.



DOWNLIGHT

STEP

OUTDOOR

Apparecchio da incasso a parete per illuminazione segnapasso direzionata con angolo di 20°, per sorgente LED integrata con alimentazione remota disponibile come accessorio. Corpo e cornice di battuta super-slim larghezza 5 mm. in metallo verniciato. Installabile anche in pareti e soffitti in calcestruzzo mediante apposita cassaforma in lamiera zincata disponibile come accessorio. Grado di protezione IP65

Recessed downlight for wall installation, for guidance lighting with 20° angle direction, for integrated LED source with remote power-supply available as an accessory. Body and super-slim 5 mm width frame in painted metal. It can also be installed in concrete or brick walls through specific galvanized steel wall-box, available as an accessory. Degree of protection IP65.







STEP 75

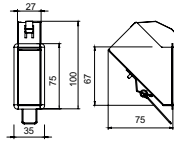
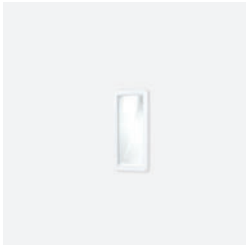

LED		lm product/beam 3000K					CODE	Col.
W	mA	Dim.	H	Kg	16°			
1,5	500	27x75	67	0,2	252	LT1983BCIP	/01 /02 /60 /99	

Accessori - accessories: LT1992: cassaforma step 75 - Wallbox step 75

STEP 150

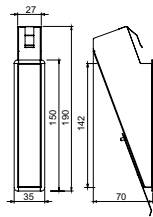

LED		lm product/beam 3000K					CODE	Col.
W	mA	Dim.	H	Kg	16°			
1,5	500	27x70	142	0,4	252	LT1982BCIP	/01 /02 /60 /99	

Accessori - accessories: LT1991: cassaforma step 150 - Wallbox step 150

STEP 300

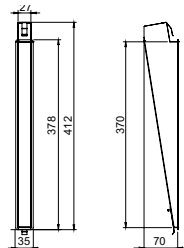

LED		lm product/beam 3000K					CODE	Col.
W	mA	Dim.	H	Kg	16°			
1,5	500	27x70	370	0,7	252	LT1981BCIP	/01 /02 /60 /99	

Accessori - accessories: LT1990: cassaforma step 300 - Wallbox step 300

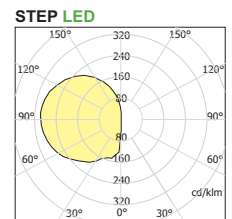

**CASSAFORMA
OUTER CASING**

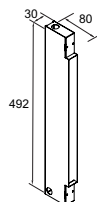
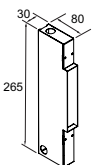
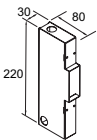

	Dim.	H	CODE
STEP75	30x80	220	LT1992

Idonea anche per calcestruzzo. Suitable for brickwall too.

	Dim.	H	CODE
STEP150	30x80	265	LT1991

Idonea anche per calcestruzzo. Suitable for brickwall too.

	Dim.	H	CODE
STEP300	30x80	492	LT1990

Idonea anche per calcestruzzo. Suitable for brickwall too.